

- Thermoplastic connector with incorporated cable entry protection
- Construction according to DIN 43650 (DIN EN 175301-803)
- Square or rectangular housing option
- Ideal to connect solenoid valves, sensors, motors, etc.
- Degree of protection IP65 (IEC 60529)
- Male/female polarized connection
- Choice of 2 contacts + ground or 3 contacts + ground
- Bases supplied with fixing screw and gasket



Specifications

Construction	according to DIN 43650 (DIN EN 175301-803)
Electrical Rating	10 A at 250 V
Nº of Contacts	2 active contacts + 1 ground or 3 active contacts + 1 ground
Contact Resistance	30 mΩ max. initial by contact
Temperature	Housing black: -30 °C ... +125 °C Housing transparent: -25 °C ... +90 °C
Degree of Protection	IP65 (for complete connector with cable entry protection) (IEC 60529)
Cable Entry	Pg 9 (cables Ø6 to 8 mm) or Pg 11 (cables Ø8 to 10 mm)
Materials	Housing: Reinforced thermoplastic black; connector with LED: transparent thermoplastic Inserts: Reinforced thermoplastic black; connector with LED: gray thermoplastic Contacts: Silver Plated Brass

Subject to change without prior notice

Connectors

Square Connector
DIN 43650 form A



Contacts	Entry	Code
3 + Gnd	Pg 9	PE3H
	Pg 11	PE5H
2 + Gnd	Pg 9	PE7H
	Pg 11	PE9H

Rectangular Connector



Contacts	Entry	Code
3 + Gnd	Pg 9	PE3HTBR

- Red led; voltage 10 to 50 Vac/Vdc
- Circuit connected between terminals 1 and 2



Contacts	Entry	Code
2 + Gnd	Pg 9	PF7H

① UL recognized component (File E205538; model A2B and B1B)

Bases (for Square Conector DIN 43650 form A)



Base - form B

Contacts	Code
3 + Gnd	PE3B
2 + Gnd	PE7B



Base - form C

Contacts	Code
3 + Gnd	PE3C
2 + Gnd	PE7C



Base - form F

Contacts	Code
3 + Gnd	PE3F
2 + Gnd	PE7F

Dimensions (in mm)

Square Connector DIN 43650 form A

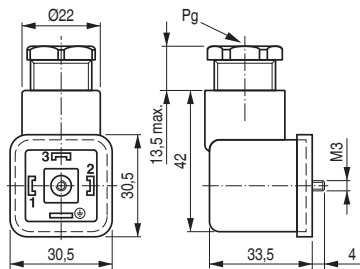

Rectangular Connector

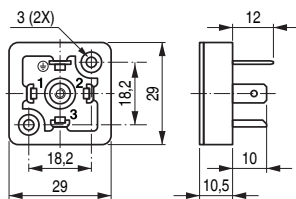
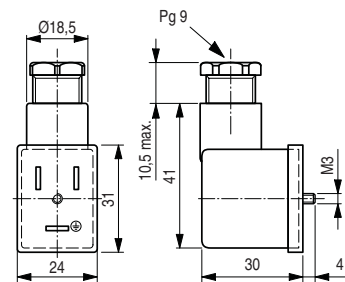

Base - form B
(for square connector)

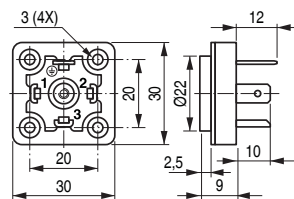

Base - form C
(for square connector)

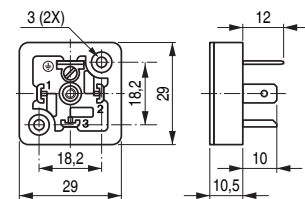

Base - form F
(for square connector)

Special Applications

The products presented in this catalog are for regular commercial use, however we are able to develop "personalized" models for special applications. Contact us. Examples:

- Connector with incorporated cable;
- Other options for LED circuits and transient suppressor circuits (with or without LED);